

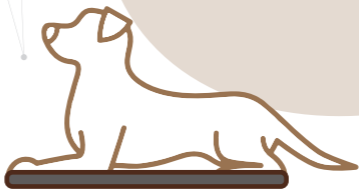

petspemf PAD
by Omnipemf

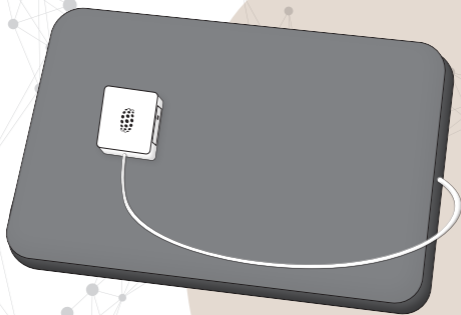

SCIENTIFICALLY TESTED & PROVEN EFFECTIVE

USER MANUAL

For animal use only

1. Introduction

In a world full of options, we want to take a moment to say thank you for choosing us. Stimulation wearables using PEMF are an excellent tool for helping your pet achieve stress relief, pain relief, and accelerated healing. Please take your time to read this user manual carefully, even if you are familiar with a similar product. To ensure your safety and the safety of your pet, please read this user manual before using Petspemf Pad. Please do not disassemble the device. It can be unsafe and will void the manufacturer's warranty.

Contents	10	Light Indicators
1 Introduction	11	How to Use Petspemf Pad Most Effectively
2 Device Description	12	Test Tube - How to Use and What Does It Tell You?
3 Included in the Package	13	Maintenance and Cleaning
4 Age Restrictions	14	Troubleshooting Guide
5 Contraindications and possible Side Effects	15	Technical and System Specifications
6 Petspemf Pad Set-Up	16	Classification
7 Petspemf Pad's Bluetooth® Settings	17	Safety Warnings
8 Controls	18	Warranty Service
9 Getting to know your Petspemf Pad	19	Disclaimer

This appliance should be used by adults over 18 years. Children over 8 years can also operate it provided that they are under adult supervision. It can be used by people with reduced physical, sensory or mental capabilities or lack of experience and knowledge if they have been given supervision or instructions concerning the use of the appliance in a safe manner and in addition to that understand the hazards involved. Children shall not play with the appliance. Children shall not clean or make any device maintenance without supervision.

This appliance contains non-replaceable batteries.

Must only be supplied with a safety extra-low voltage corresponding to the marking on the appliance.

The appliance is only to be used with the power supply unit provided with the appliance.

WARNING: To recharge the battery, use only the detachable supply unit provided with this appliance.

2. Device Description

Petspemf Pad provides pain relief, stress relief, and accelerated healing by emitting clinically and scientifically proven frequencies through electromagnetic fields. PEMF technology can be used as a stand-alone therapy or in conjunction with an existing treatment plan for your pet. Petspemf Pad is a comfortable pad with five strategically placed coils that emit frequencies. It has a protective waterproof inner cover, and a removable, washable and anti-scratch outer cover.

3. Included in the Package

- 1 x Petspemf Pad
- 1 x Special Bag
- 1 x Test tube with a magnet
- 1 x Micro USB
- 1 x Hard Reset Tool
- 1 x QR code with a link to the User Manual

4. Age Restrictions

Petspemf Pad should only be operated by individuals aged 18 years or older (“Permitted Age”). Children over 8 years can also operate it provided that they are under adult supervision.

5. Contraindications and possible Side Effects

PEMF devices are recognized to deliver treatments without reports of side effects or significant adverse events. Petspemf Pad has been developed for both home and clinical use. The device emits an electromagnetic field for which there is no valid scientific reason to believe that the electromagnetic emissions are harmful.

Petspemf Pad should not be used near people or animals with implants such as pacemakers, non-MRI-safe IUDs, cochlear implants, or mechanical heart valves.

Pet owners with such devices should keep at least 30 cm (12 inches) away from the active device. However, there are no magnetic induction effects from the Petspemf Pad’s signal on veterinary surgical implants because these are made of non-magnetic materials. If you are hesitant about using Petspemf Pad on your pet, please contact your veterinarian for further consultation.

6. Petspemf Pad Set-Up

1. Charge your Petspemf Pad for a minimum of 2.5 hours before using it for the first time.
2. On your smartphone search the Play Store or iOS App Store for PetsPemf and download the app.
3. Follow the in-app tutorial. It will guide you through connecting your device to your smartphone and completing your first Petspemf Pad session. How to connect both devices using Bluetooth® is also described in chapter 9 - Using Petspemf Pad for the first time.
4. Join Petspemf's social networks. They are a great place to learn more about the device and its features, share experience with other users, and chat with the team behind Petspemf Pad.

7. Petspemf Pad's Bluetooth® Settings

(Stimulation status in the app)

When Petspemf Pad is activated, its Bluetooth® is automatically enabled and ready to connect with your device. However, the settings in the Petspemf Pad App allow you to keep Petspemf Pad's Bluetooth® active while the stimulation process is on or to deactivate it WHILE the program is running, completely.

Bluetooth® during stimulation ON

This setting leaves Bluetooth® active also when you are using your Petspemf Pad (a stimulation program is running).

ADVANTAGES

- A countdown timer progress bar will be activated while the stimulation program is running.
- You will have access to the in-app statistics on your mobile device (duration of stimulation program used, frequency of past usage, etc.) once the program ends and the Bluetooth® connection is reestablished (automatically).
- It's easier to change stimulation programs, as your phone doesn't need to reestablish its Bluetooth® connection to Petspemf Pad. Simply select a new program and tap Petspemf Pad's control box twice or press the PLAY button in the app on your smartphone to start it.

DISADVANTAGES:

- If Bluetooth® is also active during stimulation, it emits its own (much higher) frequencies.
- Your mobile phone has to be within the Bluetooth® connectivity range of the device, or else due to connectivity loss, the data will not be synced.

Bluetooth® during stimulation OFF

This setting automatically deactivates Petspemf Pad's Bluetooth® when a stimulation program starts and activates it again when the program ends. Bluetooth® is completely disabled ONLY while the program is running.

ADVANTAGES:

- No unwanted additional frequencies emitted during stimulation, just the ones Petspemf Pad emits to aid your pet.
- You don't need your mobile device (only for setting up the program).

DISADVANTAGES:

- A countdown timer progress bar will not be activated while the stimulation program is running, as the communication via Bluetooth® is not established.
- You will have access to the in-app statistics on your mobile device (duration of stimulation program used, frequency of past usage, etc.) only when you reconnect to the app via Bluetooth®. In this case, only the last 10 sessions run will be synced.
- Your mobile device needs to re-establish the connection to Petspemf Pad every time you want to change the stimulation program. That means you will have to go to the home page and click CONNECT.
- Your mobile device won't be able to communicate with Petspemf Pad during the stimulation. Visiting the homepage, you will see the CONNECT button active (can be clicked); however, the connection will not be established because the program is running, and Petspemf Pad's Bluetooth® is OFF. You will have to stop (interrupt) the stimulation program with a double-tap on Petspemf Pad's control box and reconnect to your mobile device on the home page.

Which is better?

The ON option is selected by default, and we suggest that you leave it this way for the first few uses as it doesn't require to re-establish the connection each time you want to select a new stimulation program. You can turn it off later if you don't want the Bluetooth® to be active when you use your Petspemf Pad.

NOTE: If you are using the same stimulation program most of the time, it is recommended that you turn Bluetooth® off in the app's settings. This will allow you to use your Petspemf Pad only with the gesture controls – simply tap Petspemf Pad's control box (after waking it up) to restart your most recently used program.

How will I know that my chosen stimulation program has started/stopped if I turn off Bluetooth®?

Although you won't be able to see the progress bar, Petspemf Pad will notify you when your chosen program starts/stops with vibrations and light indicators.

8. Controls

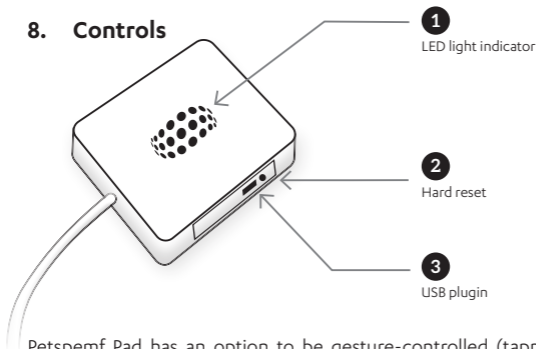

Petspemf Pad has an option to be gesture-controlled (tapping the control box with your hand) or via app on your smartphone. Bluetooth® is also not required, except for when you are changing or choosing a new program.

It is controlled by tapping the control box, so for regular use of the same program, you don't even need your smartphone. A smartphone is only used for switching among different stimulation programs or changing the settings.

USING PETSPEMF PAD FOR THE FIRST TIME

1



1. CHARGE

Charge your Petspemf Pad for a minimum of 2.5 hours when using it for the first time. Petspemf Pad is unlocked when plugged into the charger.

2



2. DOWNLOAD THE APP

Download the Petspemf App to your mobile device or tablet from the iOS App Store or Google Play store.

3



3. START THE APP

Press START and accept the Terms and Conditions. Make sure to have Bluetooth on your device turned ON and follow the step-by-step User Guide. If you are using an Android device, you will be asked to enable location services using the app.

4



4. WAKE UP THE DEVICE

Double tap the control box to wake up the device (confirmed by a double vibration) - at this point the device is ready to use.

5



5. CONNECT

Click the CONNECT button in the app and wait until Petspemf Pad pairs with your device.

6



6. START SESSION

Once you select a program, set your duration and the session will begin (followed by single vibration). To stop a session, either press the STOP button in the app or double tap the control box (followed by double vibration).

How to check if stimulation is in progress?

Check if the green light is blinking (1 blink per second). Each stimulation program also starts with 1 short vibration. You can also use the test tube with a magnet to confirm the presence of a magnetic field.

How to check if Petspemf Pad is charging?

Orange light means it's charging. No light while charging means it's fully charged. Blinking red light (1 blink per second) means the battery is low.

How do I know Petspemf Pad is connected to my phone?

Blinking orange light (1 blink per second) means it's connected to your mobile device (and no program is running).

9. Getting to know your Petspemf Pad

RESTARTING THE MOST RECENTLY USED PROGRAM

For example, if the last time you used Petspemf Pad was the Pain relief program yesterday, the device is still set on that program. If you want to use it again, you don't need your smartphone to start it. To start the last used program, first, firmly tap the control box once to wake up the pad and then tap it twice to start the last used program. The start of the program is confirmed by 1 short vibration. See the LED light indicator to check the status of the device. A blinking green light once per second means the program is running.

Note: Petspemf Pad does not require the use of your smartphone while the program is running.

USING A DIFFERENT PROGRAM

If you want to start a different program from the most recently used one and Petspemf Pad is turned off, first tap the control box once to wake it up. Make sure the Bluetooth® connection is established (orange light blinking every second). In the app choose your desired program and press the START button in the app. Tap Petspemf Pad's control box twice and the new program will start (confirmed by 1 short vibration). See the LED light indicator to check the status of the device. Blinking green light (1 blink per second) means the program is running.

If a program is currently running and you want to start using another program, first tap Petspemf Pad's control box twice to stop the current program (confirmed by 2 short vibrations) or press STOP, select the new program, desired time of use, and press the START button in the app. Tap Petspemf Pad's control box twice again, and the new program will start (confirmed by 1 short vibration). See the LED light indicator to check the status of the device. A blinking green light once per second means the program is running.

STOPPING THE RUNNING PROGRAM

If you want to stop a running program to select and initialize another one, double-tap the control box to interrupt the program already running; the device will vibrate twice, meaning the program has stopped. Then choose the desired program and double-tap the control box again. If you want to stop a running program and stop using the device, all you need to do is tap the control box twice (confirmed by 2 short vibrations), and leave it. Petspemf Pad will turn off by itself.

USING THE HARD RESET TOOL

If you encounter a problem and Petspemf Pad stops functioning, you can use the hard reset feature.

When should you use hard reset?

- No response when charging the device,
- Wrong LED light color when charging/done charging/starting a new program (check the light signals described in the next chapter).

Always check if the battery is full. When resetting the device, insert the hard reset tool into the hole close to the micro USB port and push gently.

To keep you updated on the current state of the device, Petspemf Pad has integrated 3 different color light indicators - orange, red, and green LED lights. Read more about them in the next chapter.

USING THE "LOCK PETSPEMF PAD" FUNCTION IN THE APP

If you want to turn Petspemf Pad off completely, connect to the device via Bluetooth®, go under settings, and click LOCK Petspemf Pad. This will completely shut it down and lock it to prevent further use. To start using it again, plug it into a USB port to unlock it. All the statistics will be stored in the app.

When to use this function?

You can lock your Petspemf Pad when traveling or carrying it in a bag or a suitcase for more extended periods to prevent unintentional use.

10. Light Indicators

The LED lights on the left side of the flat surface of the device indicate the working state of Petspemf Pad. Petspemf Pad has integrated orange, red, and green lights.

1. Blinking red light: The battery is low and you have to recharge the device.
2. Blinking orange light (1 blink per second): Petspemf Pad is connected to your phone via Bluetooth®.
3. Orange light on: Petspemf Pad is charging, USB is plugged in.
4. No light on when charging: Petspemf Pad is fully charged.
5. Blinking green light (1 blink per second): The chosen stimulation program is running.
6. Slowly blinking green light (1 blink per 5 seconds): Petspemf Pad is on standby; USB is unplugged.

11. How to Use Petspemf Pad Most Effectively

Petspemf Pad has five specially designed coils that generate electromagnetic fields and are powered by a pulse generator inside the device. Because of the wide active area, the pad is easy to use as owners just put the pad under or over the animal and select a program. The most suitable time for this is when they are resting or sleeping. All our pets need to do is to lay down and relax. The pad is thin so it can be placed on an existing pet bed, in a crate or a transport box.

It is recommended to keep your pet hydrated while using Petspemf Pad to help facilitate the natural release of toxins. It is also important to feed your pet a healthy diet, combine both dry and wet pet food.

Petspemf Pad has three designated programs for different pet needs. See the table below to see which program is best for your pet, which frequency it uses and for how long you should use it for.

For more information please see: <https://petspemf.com/support/>

	Pain relief	Stress relief	Accelerated healing
Dominant frequency:	50.6 Hz	4 Hz	15.2 Hz
Intensity:	2.5 mT	2.5 mT	2.5 mT
Accompanying frequency:	15.2 Hz	6 Hz	40.5 Hz
Intensity:	1 mT	1 mT	1 mT
Positions:	Over the wound or affected area	The whole body (lying on the pad)	Over the wound or affected area
Suggested use:	A few times per day until needed	A few times per day until needed	A few times per day until needed

12. Test Tube - How to Use and What Does It Tell You?

In most cases, the non-invasive pulses are not tangible. Because of that reason, we added a magnetic tester tube in the Petspemf Pad package, with which you can hear the impulses emitted by the device. It can be used to confirm that a stimulation program is running (Petspemf Pad emits an electromagnetic field when active and the magnet reacts to it - you can hear a sound when listening to the test tube).

You can also test the frequency of pulsed electromagnetic fields in different stimulation programs, as well as observe the change in the strength of the electromagnetic field as the test tube moves away from or closer to Petspemf Pad.

What do you actually hear when using the tube?

As the magnet in the tube reacts to the magnetic field produced, you get to hear the frequency of the electromagnetic pulses emitted by the coils inside Petspemf Pad.

Testing the FREQUENCY of different stimulation programs

Choose the desired program in the application, run it, and place the test tube on the surface of the pad where the coils are (see image below for reference). That is where the coils are placed and the impulses can be heard. If you, for example, choose the Pain program, you will be able to hear a high frequency, because this program uses beta frequencies. It will sound like a fast vibration. The test tube must touch the device. Place the glassy bottom of the tube on the device and place your ear on the other side where the silver cap is.

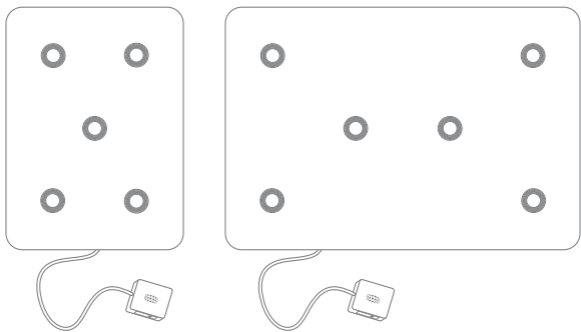

Testing the STRENGTH of the electromagnetic field

Turn on the device. Move the test tube close to Petspemf Pad and listen carefully. The magnet in the test tube will produce a sound. The sound will be more intense and louder when the test tube is closer to Petspemf Pad. If you increase the distance, the sound will slowly fade away. This happens because the intensity of the magnetic field decreases with distance from the surface of the device.

13. Maintenance and Cleaning

Do not use Petspemf Pad near water or when your pet is wet. Petspemf Pad's outer fabric can be removed and washed in a washing machine, up to 30 °C.

If needed Petspemf Pad can be folded in a certain way. Folding it improperly may result in ineffectiveness or damage to the coils. Avoid excessive physical impact to the device, and do not stretch or bend it as this can damage the copper coils and the hardware. The manufacturer does not take responsibility for devices damaged by improper use. The device should only be used on flat surfaces.

Correct folding of the device is shown below:

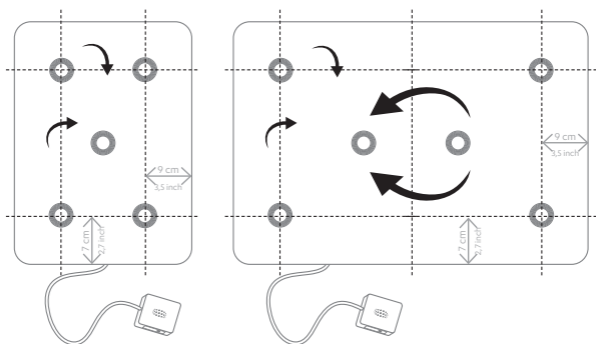

14. Troubleshooting Guide

Please know that we are here for you. If you have any questions that this user manual does not resolve, please contact us through our social media (Facebook or Instagram) or fill out the contact form on our website www.petspemf.com/support. Our support team will reach out to you as soon as possible.

The LED indicator is not working.

Recharge the battery. Check the USB cable.

The device has been exposed to excessive amounts of water.

Petspemf Pad is not designed to be waterproof, although short exposure to water may not permanently damage the device. If your Petspemf Pad has been exposed to water, remove its fabric cover and place it somewhere to dry.

15. Technical and System Specification

Operating system	Android 5.0 and above iOS 7 and above
Waveform	Trapezoidal
Frequency Range	4 – 50.6 Hz
Maximum Magnetic Field Intensity	25 gauss (2.5 mT)
Number of Programs	3
Program Duration	20min, 30min, 40min, 4 hours and 8 hours
Power	Internal rechargeable battery
Weight	295 g and 590 g
Dimensions	330 mm (13 in) x 445 mm (17.5 in) x 20mm (0.8 in) And 700 mm (27.5 in) x 445 mm (17.5 in) x 20mm (0.8 in)
Warranty	2 years

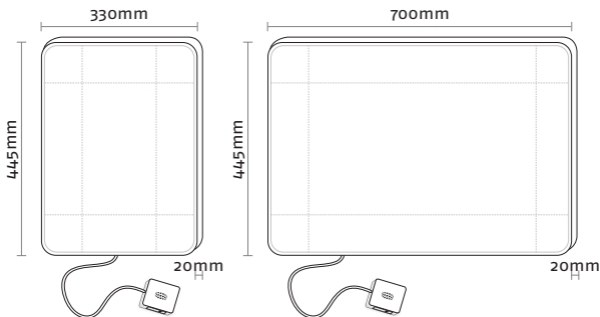

18. Classification

Petspemf Pad is classified as a household device.



CE regulatory information:

Safety: EN 60335-1

Electromagnetic Compatibility (EMC):

EN 303 446-1

Radio Equipment Directive (RED): 2014/53/EU



We are proud to use recyclable materials for our packaging to help protect the environment.

FCC regulatory information:

device complies with part 15 of the FCC Rules

17. Safety warnings

- Do not expose Petspemf Pad to fire, place it near a hot oven, or mechanically crush or cut the device or its battery, as this may result in an explosion.
- Do not expose Petspemf Pad to extremely high temperatures, as this may result in an explosion or leakage of flammable liquid or gas.
- Do not expose Petspemf Pad to extremely low air pressure, as this may result in an explosion or leakage of flammable liquid or gas.
- Don't attempt to replace Petspemf Pad's battery yourself – you may damage the battery, which could cause overheating and/or injuries.
- Be careful when folding Petspemf Pad, see instructions for correct folding. If folded improperly this may result in ineffectiveness or damage to the coils.
- Do not use Petspemf Pad near water or when your pet is wet, as the device is not waterproof.

18. Warranty Service

MANUFACTURER

MDCN TECH Ltd

Made in Europe

WARRANTY SERVICE

Contact: Contact form at www.petspemf.com/support

Our warranty policy covers physical and digital defects. All devices purchased through petspemf.com or any other official sale channels of MDCN Tech Ltd are covered by this warranty. If a device exhibits physical or digital defects that affect its functioning and this is verified by our customer support team, then a replacement or direct compensation is in line with this Warranty Policy. The Warranty Policy is active for two (2) years after the device is received by the customer, with a maximum extension of twenty-six (26) months. If a defect is verified and replacement approved, a new replacement product will be sent to the customer using the address and shipping instructions of their original order, unless requested otherwise. We offer no replacements or refunds for any products designated on this site as non-returnable. The warranty is not applicable in the following cases:

- Failure or damage to the device or its components due to improper use.
- Damage and contamination of the device caused by improper protection.
- The removal or tearing of the device's inner quality seal (sticker) which protects the electronic components and cushion.
- If the device's hardware or software has been opened, accessed and/or modified from its original functioning state.

19. DISCLAIMER

MDCN TECH LTD and its distributors offer low risk, general wellness products that promote a healthy lifestyle for your pet. Our products encourage good health, and reduce the impact or risk of some chronic animal diseases and conditions.

These statements have not been evaluated by the FDA and products are not intended to diagnose, treat, mitigate, cure, or prevent any disease or medical condition. PEMF products are meant to address energetic elements that aid the natural healing abilities of an animal, and help restore and maintain energetic balance.

Petspemf Pad should not be used near people or animals with implants such as pacemakers, non-MRI-safe IUDs, cochlear implants, or mechanical heart valves. Pet owners with such devices should keep at least 30 cm (12 inches) away from the active device. Depending on the material used, there are no magnetic induction effects from the

Petspemf Pad's signal on veterinary surgical implants because these are usually made of non-magnetic materials. If you are hesitant about using Petspemf Pad on your pet, please contact your veterinarian for further consultation.

If your animal has or you suspect a medical problem, please consult a veterinarian. Content generated or found through MDCN TECH LTD services or products is for informational purposes only and is not intended to replace the relationship you and your veterinarian or other animal healthcare providers have. MDCN TECH LTD is not a licensed medical or healthcare provider and has no expertise in diagnosing, examining, or treating medical conditions of any kind. The information you read in this user manual, website or in the application is not a substitute for professional veterinarian advice.

Petspemf devices are considered medical products by the FDA and must be used under the guidance of a licensed veterinarian. The information provided by MDCN TECH Ltd is for informational purposes only and should not be used as a substitute for professional veterinary advice.

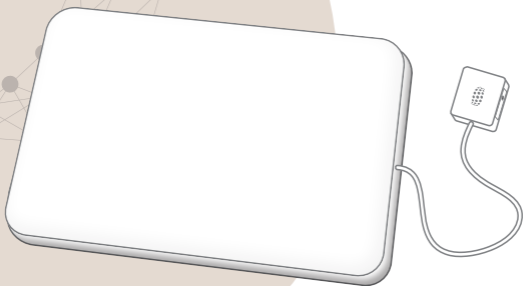

App store



Google play



www.petspemf.com