

USING PETSPEMF PAD FOR THE FIRST TIME

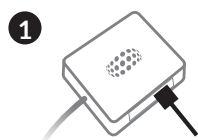

1. CHARGE

Charge your Petspemf Pad until the orange light disappears. Petspemf Pad can also be unlocked when plugged into the charger.



2. DOWNLOAD THE APP

Download the Petspemf App to your mobile device or tablet from the iOS App Store or Google Play store.



3. START THE APP

Press START and accept the Terms and Conditions. Make sure to have Bluetooth on your device turned ON and follow the step-by-step User Guide.



4. WAKE UP THE DEVICE

Double tap the control box to wake up the device (confirmed by a double vibration) - at this point the device is ready to use.



5. CONNECT

Click the CONNECT button in the app and wait until Petspemf Pad pairs with your device.



6. START SESSION

Once you select a program, set your duration and the session will begin (followed by single vibration). To stop a session, either press the STOP button in the app or double tap the control box (followed by double vibration).

7. BLUETOOTH CONNECTION

There is no need to pair the device on your phone or tablet's Bluetooth settings - the Petspemf device only needs connectivity through the app, and disconnects it after some time to save your phone's battery.

HOW TO USE THE TEST TUBE

Using the Test Tube is very simple. Here are three steps for you to follow:

1. Choose the Pain Relief program as its frequencies are most audible
2. Place the glass end of the Test Tube on the area of the coil
3. Place your ear on the silver cap of the Test Tube to hear the pulses

As the magnet in the tube reacts to the magnetic fields being produced, you will hear the frequency of the electromagnetic pulses emitted by the coils of the Petspemf Pad. The sound should be quite faint, without any significant noise, and should produce more of a buzz than an extreme rattle. The magnet will remain static, and won't be jumping or shaking up and down.

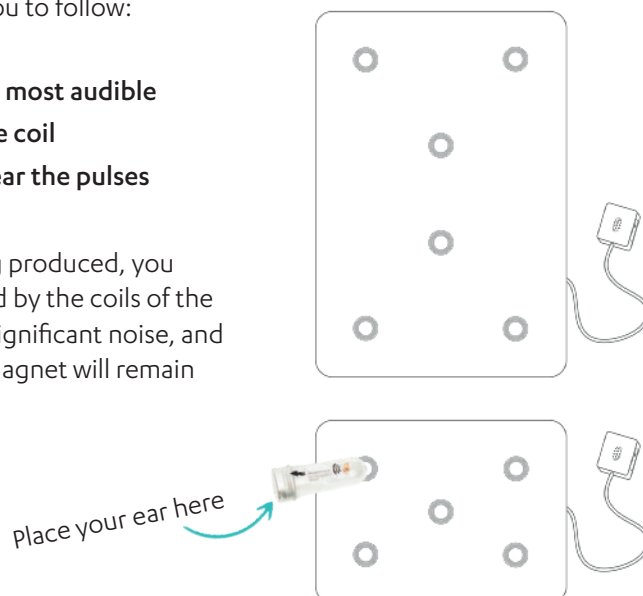

WHAT DOES EACH LIGHTS SIGNIFY?

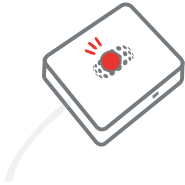

1. RED LIGHT

Blinking red light: The battery is low and you have to recharge the device.

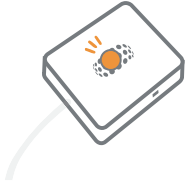

2. ORANGE LIGHT

Blinking orange light(1 blink per second): Petspemf Pad is connected to your phone via Bluetooth®.

Orange light on: Petspemf Pad is charging, USB is plugged in.



3. GREEN LIGHT

Blinking green light(1 blink per second): The chosen stimulation program is running.

Slowly blinking green light (1 blink per 5 seconds): Petspemf Pad is on standby; USB is unplugged.

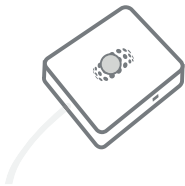

4. NO LIGHT

No light on when charging: Petspemf Pad is fully charged.